

## Floor Plans

**Choose from three floor plan options to fit your individual needs and preferences:**

**Studio:** 204 square feet

- Base housing fee: \$900
- Built-in closet, cabinetry and bookshelves
- Wheelchair accessible lavatory



**Suite:** 385 square feet

- Base housing fee: \$1200
- Living area and sleeping room
- In-suite kitchenette with refrigerator/ freezer, sink and microwave
- Full bathroom with wheelchair accessible shower
- Built-in closet, cabinetry and bookshelves

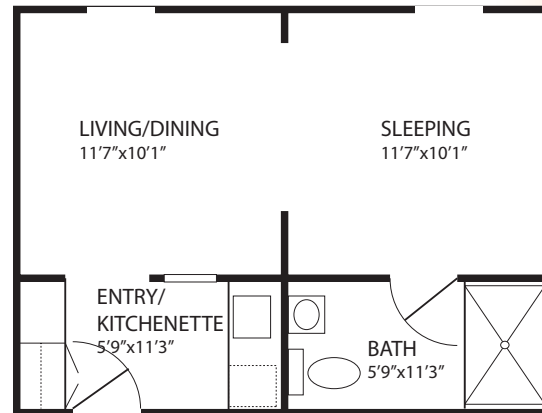

**2 Bedroom Suite:** 589 square feet

- Base housing fee: \$1900
- Living area and two sleeping rooms
- In-suite kitchenette with refrigerator/ freezer, sink and microwave
- Full bathroom with wheelchair accessible shower
- Half bath
- Built-in closet, cabinetry and bookshelves

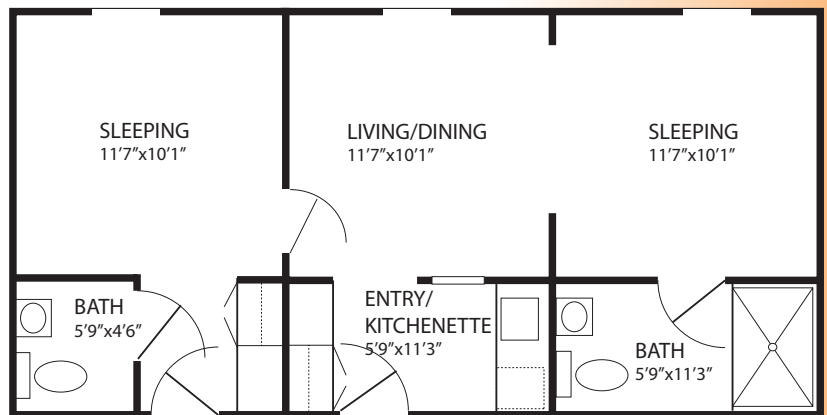

## Services Included in Housing Fee

- Chef-prepared meals
- Escorts to meals and activities
- Chaplaincy services
- Nurse liaison with health care professionals
- Nurse maintains clinical record
- Nurse provides specialized personal care services
- Assistance and coordination of community resources
- Local transportation
- Assistance and coordination for out-of-town transportation

**Additional personal care levels are identified during initial assessment and periodically reviewed and adjusted based on your needs.**